

POLY – V TAPER-LOCK® PULLEYS

Types

Grooved pulleys designed for industrial transmissions are identified by reference to the dimensions and the groove pitch in the following types: **PPV-J – PPV-L**

Profile dimensions

The transverse profile dimensions of a grooved pulley are shown in the figure and in the table.

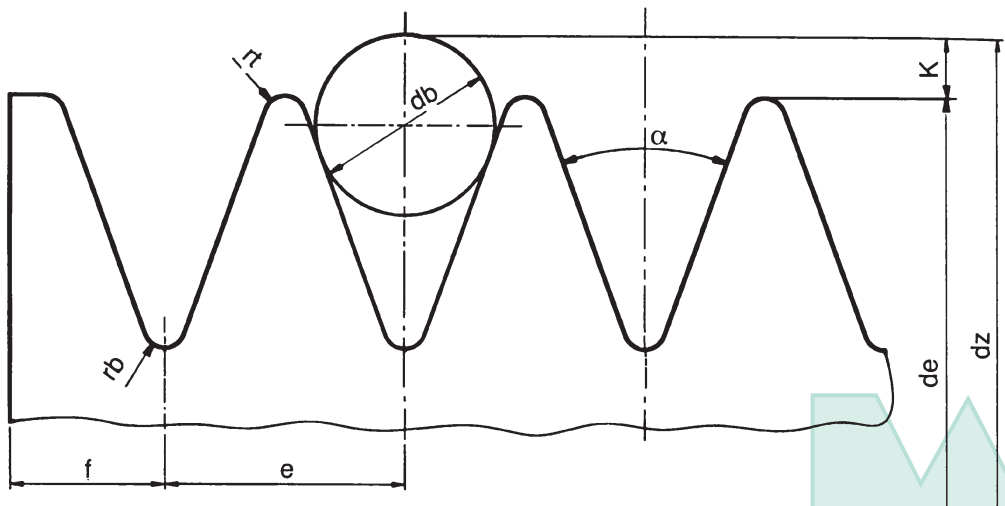

TABLE

| Type | PPV-J | PPV-L |
|---|-------|-------|
| Grooves pitch e | 2.34 | 4.70 |
| Tolerance for e* | ±0.03 | ±0.05 |
| Sum of tolerances e** | ±0.30 | ±0.30 |
| Race angle α** ±0,5 | 40° | 40° |
| rt min. | 0.20 | 0.40 |
| rb max. | 0.40 | 0.40 |
| Diameter of the control sphere or roller db ± 0.01 | 1.50 | 3.50 |
| 2K** nominal | 0.23 | 2.36 |
| f min. | 1.8 | 3.3 |

* = this tolerance applies to the distance between the axes of two consecutive grooves

** = the sum of all the tolerances "e" for all the races of each pulley must not exceed the value foreseen in the table

* = the axis of each groove must form a $90^\circ \pm 0.5^\circ$ angle with the pulley axis

** = K is not in relation to the pulley's nominal diameter but is measured from the position of the measurement sphere or roller.

DIMENSIONS OF POLY-V TAPER-LOCK® PULLEYS

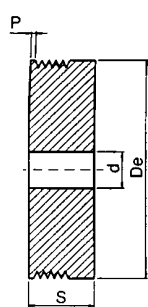

EXECUTION 1

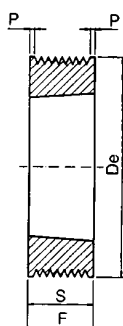

EXECUTION 2

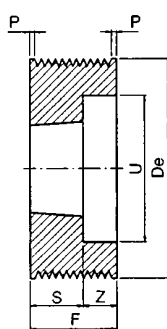

EXECUTION 3

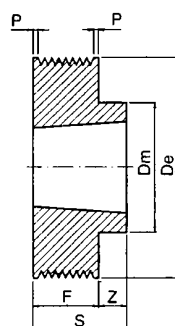

EXECUTION 4

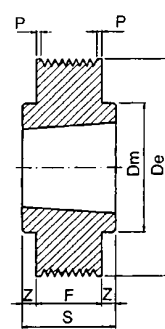

EXECUTION 5

PPV - J CROSS-SECTION

| De | Exec. | No. of Races | Bush | S | Z | Dm | U | d | De | Exec. | No. of Races | Bush | S | Z | Dm | U |
|-----|-------|--------------|------|------|-----|----|----|----|-----|-------|--------------|------|----|------|-----|----|
| 40 | 1 | 8 | - | 32 | - | - | - | 12 | 106 | 4 | 8 | 1610 | 26 | 3 | 82 | - |
| | 1 | 12 | - | 41.5 | - | - | - | 12 | | 3 | 12 | 1610 | 26 | 6.5 | - | 88 |
| | 1 | 16 | - | 51 | - | - | - | 12 | | 3 | 16 | 1610 | 26 | 16 | - | 88 |
| 45 | 1 | 8 | - | 32 | - | - | - | 12 | 112 | 4 | 8 | 1610 | 26 | 3 | 90 | - |
| | 1 | 12 | - | 41.5 | - | - | - | 12 | | 3 | 12 | 1610 | 26 | 6.5 | - | 88 |
| | 1 | 16 | - | 51 | - | - | - | 12 | | 3 | 16 | 1610 | 26 | 16 | - | 88 |
| 50 | 1 | 8 | - | 32 | - | - | - | 12 | 118 | 4 | 8 | 1610 | 26 | 3 | 90 | - |
| | 1 | 12 | - | 41.5 | - | - | - | 12 | | 3 | 12 | 2012 | 32 | 0.5 | - | 98 |
| | 1 | 16 | - | 51 | - | - | - | 12 | | 3 | 16 | 2012 | 32 | 10 | - | 98 |
| 56 | 2 | 8 | 1108 | 23 | - | - | - | - | 125 | 4 | 8 | 1610 | 26 | 3 | 90 | - |
| | 1 | 12 | - | 41.5 | - | - | - | 12 | | 3 | 12 | 2012 | 32 | 0.5 | - | 98 |
| | 1 | 16 | - | 51 | - | - | - | 12 | | 3 | 16 | 2012 | 32 | 10 | - | 98 |
| 63 | 2 | 8 | 1108 | 23 | - | - | - | - | 132 | 4 | 8 | 1610 | 26 | 3 | 90 | - |
| | 3 | 12 | 1108 | 23 | 9.5 | - | 46 | - | | 3 | 12 | 2012 | 32 | 0.5 | - | 98 |
| | 1 | 16 | - | 51 | - | - | - | 12 | | 3 | 16 | 2012 | 32 | 10 | - | 98 |
| 71 | 2 | 8 | 1108 | 23 | - | - | - | - | 140 | 4 | 8 | 1610 | 26 | 3 | 90 | - |
| | 3 | 12 | 1108 | 23 | 9.5 | - | 46 | - | | 4 | 12 | 2517 | 45 | 12.5 | 120 | - |
| | 2 | 16 | 1215 | 42 | - | - | 55 | - | | 4 | 16 | 2517 | 45 | 3 | 120 | - |
| 75 | 2 | 8 | 1108 | 23 | - | - | - | - | 160 | 5 | 8 | 2012 | 32 | 4.5 | 110 | - |
| | 3 | 12 | 1610 | 26 | 6.5 | - | 60 | - | | 4 | 12 | 2517 | 45 | 12.5 | 120 | - |
| | 3 | 16 | 1610 | 26 | 16 | - | 60 | - | | 4 | 16 | 2517 | 45 | 3 | 120 | - |
| 80 | 4 | 8 | 1610 | 26 | 3 | 70 | - | - | 180 | 5 | 8 | 2012 | 32 | 4.5 | 110 | - |
| | 3 | 12 | 1610 | 26 | 6.5 | - | 60 | - | | 5 | 12 | 2517 | 45 | 6.25 | 120 | - |
| | 3 | 16 | 1610 | 26 | 16 | - | 60 | - | | 5 | 16 | 2517 | 45 | 1.5 | 120 | - |
| 85 | 4 | 8 | 1610 | 26 | 3 | 70 | - | - | 200 | 5 | 8 | 2012 | 32 | 4.5 | 110 | - |
| | 3 | 12 | 1610 | 26 | 6.5 | - | 60 | - | | 5 | 12 | 2517 | 45 | 6.25 | 120 | - |
| | 3 | 16 | 1610 | 26 | 16 | - | 60 | - | | 5 | 16 | 2517 | 45 | 1.5 | 120 | - |
| 90 | 4 | 8 | 1610 | 26 | 3 | 70 | - | - | 224 | 5 | 8 | 2012 | 32 | 4.5 | 110 | - |
| | 3 | 12 | 1610 | 26 | 6.5 | - | 74 | - | | 5 | 12 | 2517 | 45 | 6.25 | 120 | - |
| | 3 | 16 | 1610 | 26 | 16 | - | 74 | - | | 5 | 16 | 2517 | 45 | 1.5 | 120 | - |
| 95 | 4 | 8 | 1610 | 26 | 3 | 82 | - | - | 250 | 5 | 8 | 2012 | 32 | 4.5 | 110 | - |
| | 3 | 12 | 1610 | 26 | 6.5 | - | 74 | - | | 5 | 12 | 2517 | 45 | 6.25 | 120 | - |
| | 3 | 16 | 1610 | 26 | 16 | - | 74 | - | | 5 | 16 | 2517 | 45 | 1.5 | 120 | - |
| 100 | 4 | 8 | 1610 | 26 | 3 | 82 | - | - | | | | | | | | |
| | 3 | 12 | 1610 | 26 | 6.5 | - | 74 | - | | | | | | | | |
| | 3 | 16 | 1610 | 26 | 16 | - | 74 | - | | | | | | | | |

| No. of Races | F±0.1 | P |
|--------------|-------|------|
| 8 | 23 | 3.31 |
| 12 | 32.5 | 3.38 |
| 16 | 42 | 3.45 |

DIMENSIONS OF POLY-V TAPER-LOCK® PULLEYS

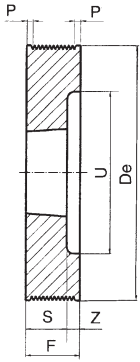

EXECUTION 3

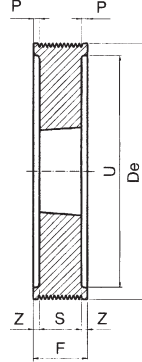

EXECUTION 6

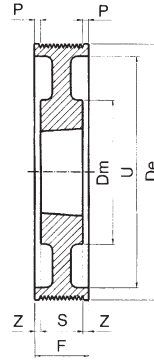

EXECUTION 7

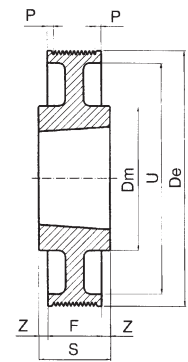

EXECUTION 8

PPV – L CROSS-SECTION

| PPV – L CROSS-SECTION | | | | | | | | | | | | | | | | | |
|-----------------------|-------|----------------|------|----|------|----|-----|--|--|-----|-------|----------------|------|----|------|-----|-----|
| De | Exec. | No. of Grooves | Bush | S | Z | Dm | U | | | De | Exec. | No. of Grooves | Bush | S | Z | Dm | U |
| 75 | 3 | 8 | 1210 | 26 | 22 | - | 56 | | | 140 | 3 | 8 | 2517 | 45 | 3 | 82 | 116 |
| | 3 | 12 | 1215 | 42 | 25 | - | 56 | | | | 6 | 12 | 2517 | 45 | 11 | - | 116 |
| | | | | | | | | | | | 6 | 16 | 2517 | 45 | 20.5 | - | 116 |
| 80 | 3 | 8 | 1210 | 26 | 22 | - | 56 | | | 150 | 3 | 8 | 2517 | 45 | 3 | - | 126 |
| | 3 | 12 | 1215 | 42 | 25 | - | 56 | | | | 6 | 12 | 2517 | 45 | 11 | - | 126 |
| | | | | | | | | | | | 6 | 16 | 2517 | 45 | 20.5 | - | 126 |
| 85 | 3 | 8 | 1210 | 26 | 22 | - | 61 | | | 160 | 3 | 8 | 2517 | 45 | 3 | - | 136 |
| | 3 | 12 | 1215 | 42 | 25 | - | 61 | | | | 6 | 12 | 2517 | 45 | 11 | - | 136 |
| | 6 | 16 | 1215 | 42 | 22 | - | 61 | | | | 6 | 16 | 3020 | 52 | 17 | - | 136 |
| 90 | 3 | 8 | 1610 | 26 | 22 | - | 66 | | | 170 | 3 | 8 | 2517 | 45 | 3 | - | 146 |
| | 3 | 12 | 1615 | 42 | 25 | - | 66 | | | | 6 | 12 | 2517 | 45 | 11 | - | 146 |
| | 6 | 16 | 1615 | 42 | 22 | - | 66 | | | | 6 | 16 | 3020 | 52 | 17 | - | 146 |
| 95 | 3 | 8 | 1610 | 26 | 22 | - | 71 | | | 180 | 3 | 8 | 2517 | 45 | 3 | - | 146 |
| | 3 | 12 | 1615 | 42 | 25 | - | 71 | | | | 6 | 12 | 2517 | 45 | 11 | - | 146 |
| | 6 | 16 | 1615 | 42 | 22 | - | 71 | | | | 6 | 16 | 3020 | 52 | 17 | - | 146 |
| 100 | 3 | 8 | 1610 | 26 | 22 | - | 76 | | | 200 | 7 | 8 | 2517 | 45 | 1.5 | 120 | 156 |
| | 3 | 12 | 2012 | 32 | 35 | - | 79 | | | | 7 | 12 | 2517 | 45 | 11 | 120 | 156 |
| | 6 | 16 | 2012 | 32 | 27 | - | 79 | | | | 6 | 16 | 3020 | 52 | 17 | - | 156 |
| 106 | 3 | 8 | 1610 | 26 | 22 | - | 82 | | | 224 | 7 | 8 | 2517 | 45 | 1.5 | 120 | 202 |
| | 3 | 12 | 2012 | 32 | 35 | - | 82 | | | | 7 | 12 | 3020 | 52 | 7.5 | 146 | 202 |
| | 6 | 16 | 2012 | 32 | 27 | - | 82 | | | | 7 | 16 | 3020 | 52 | 17 | 146 | 202 |
| 112 | 3 | 8 | 1610 | 26 | 22 | - | 88 | | | 250 | 8 | 8 | 3020 | 52 | 2 | 146 | 228 |
| | 3 | 12 | 2012 | 32 | 35 | - | 88 | | | | 7 | 12 | 3020 | 52 | 7.5 | 146 | 228 |
| | 6 | 16 | 2012 | 32 | 27 | - | 88 | | | | 8 | 16 | 3535 | 89 | 1.5 | 178 | 228 |
| 118 | 3 | 8 | 2012 | 32 | 16 | - | 94 | | | 280 | 8 | 8 | 3020 | 52 | 2 | 146 | 256 |
| | 6 | 12 | 2517 | 45 | 11 | - | 97 | | | | 7 | 12 | 3020 | 52 | 7.5 | 146 | 256 |
| | 6 | 16 | 2517 | 45 | 20.5 | - | 97 | | | | 8 | 16 | 3535 | 89 | 1.5 | 178 | 256 |
| 125 | 3 | 8 | 2012 | 32 | 16 | - | 101 | | | 315 | 8 | 8 | 3020 | 52 | 2 | 146 | 285 |
| | 6 | 12 | 2517 | 45 | 11 | - | 101 | | | | 8 | 12 | 3535 | 89 | 11 | 178 | 285 |
| | 6 | 16 | 2517 | 45 | 20.5 | - | 101 | | | | 8 | 16 | 3535 | 89 | 1.5 | 178 | 285 |
| 132 | 3 | 8 | 2012 | 32 | 16 | - | 108 | | | | | | | | | | |
| | 6 | 12 | 2517 | 45 | 11 | - | 108 | | | | | | | | | | |
| | 6 | 16 | 2517 | 45 | 20.5 | - | 108 | | | | | | | | | | |

| No. of Grooves | F±0.1 | P |
|----------------|-------|------|
| 8 | 48 | 7,55 |
| 12 | 67 | 7,65 |
| 16 | 86 | 7,75 |